

TWECO® Style Head Euro Style Termination

M400 TE is a newly designed, heavy-duty, durable, light weight MIG gun, equipped with a push-on nozzle as well as a comfortable ergonomic handle and Tweco® style torch head with Euro style termination.

This MIG gun possesses a unique capability of converting its termination style to other common styles such as Lincoln® style, Tweco® style, or Miller® style by simply replacing the installed Euro style termination kit with the desired one.



FEATURES

- Knuckle joint for improved balance and position-ability ensures that minor movements of the handle and neck be independent of the cable assembly .
- Excellent heat, abrasion resistance, and flexibility of the cable .
- Lighter than standard cable sets and capable to withstand over 1 million flexes in life testing .
- Extremely durable contact tips manufactured from premium grade copper alloys .
- Standard, durable, and high-performance options for tip adaptors, diffusers, and swan necks .
- Improved insulation and minimized heat transfer to the handle .
- Ergo design handle and comfortable handling .
- Light gun handle, less tiredness of the welder because of the special gun design .

Rating : 320A CO₂ 270A mixed gas

@ 60% duty cycle.

(as Standard IEC EN60974-7)



Recommended For :

Solid wires: 0.030 to 1/16 in. (0.8 to 1.6 mm)

Flux cored wires: 0.030 to 1/16 in. (0.8 to 1.6 mm)

Aluminum wires: 0.040 to 1/16 in. (1.0 to 1.6 mm)

Gun Length : 15ft. (4.5m)

Recommended Gas Flow :

22-27 CHF (11-13 l/min)

for 1/2 inch (12.8 mm) nozzle bore

30-35 CHF (14-17 l/min)

for 5/8 inch (16.0 mm) nozzle bore

30-40 CHF (14-19 l/min)

for 3/4 inch (19.0 mm) nozzle bore



**Euro Style
Termination**

- Air gap technology for cooler running handles and better heat transfer isolator from the swan neck .
- Steel and combo liner for all kinds of wires such as steel (metalcore and flux-cored), stainless steel (metalcore and flux-cored), and Aluminum .
- Unique sealing ring for effective sealing of impurities especially in the argon gas process .
- Reduction in welder fatigue by improved handle design for welder's comfort .
- Push on nozzle system and easy nozzle stick-out adjustment .
- High-quality trigger with a life expectancy of greater than 1 million cycles .

AIR-COOLED MIG WELDING GUN, M400 SERIES

M400 TE

Rating : 320A CO₂ 270A mixed gas @ 60% duty cycle.
(as Standard IEC EN60974-7) Length 15 ft. (4.5m)

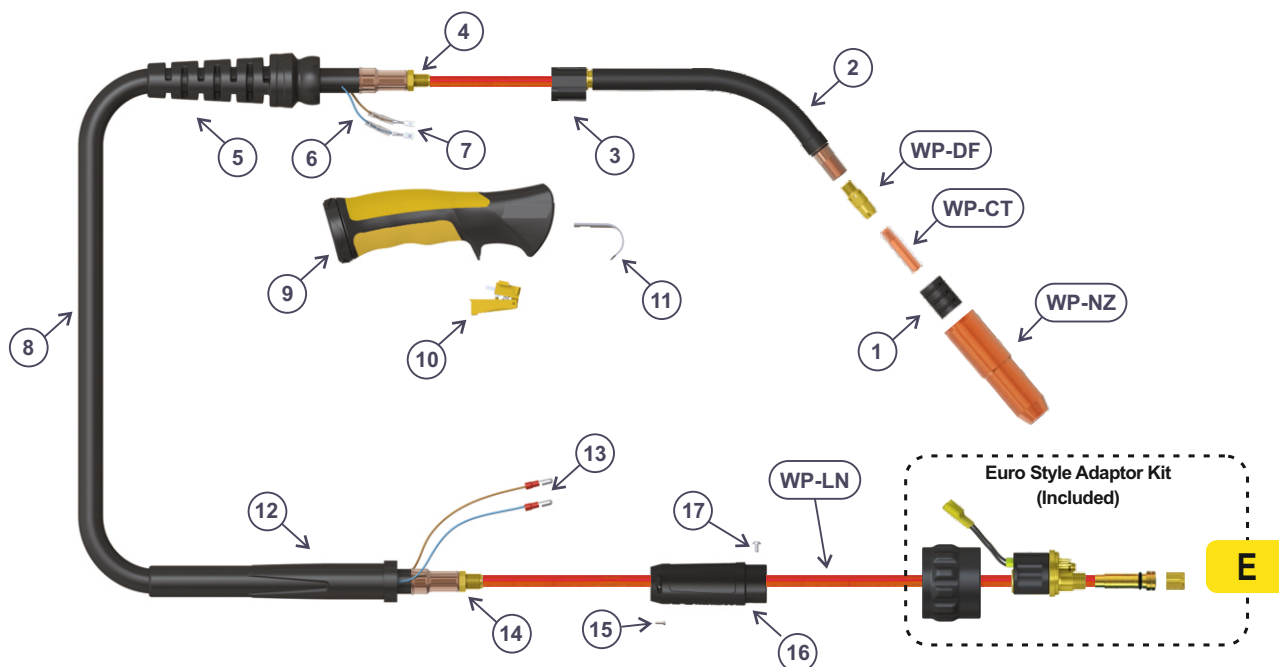

M400 TE

MIG Welding GUN Euro Style Termination, 15 ft. (CWGPGTW400-15E)

Item	Description	Part Number	Item	Description	Part Number
1	Adjustable Nozzle Insulator	CWU32	12	Cable Support	CWUC2841
2	Swan Neck Assembly	CWULS-TW2	13	Cable Terminal Male	CWUB1522
3	Ergo Handle Location Body	CWUG1515	14	Cable End Lock Nut (M12 X 1.0)	CWUXL1542
4	Lock Nut	CWUB1505	15	Handle Screw	CWUSCSP1-1
5	Handle Cable Support C/W Ball Joint	CWUG8015-BK	16	Gun Plug Housing	CWUSC2578H/S
6	Cable Terminal Cover	CWUB1521-C	17	Gun Plug Screw	CWUBL1541
7	Cable Terminal	CWUB1521	E	Euro Style Adaptor Kit	CWUECEE1575K
8	Cable Assembly X 15ft	CWUSTH300-15E	WP-NZ	Wear Part - Nozzle	See the next pages
9	Handle and Lock Nut Assembly	CWUG2514-BK	WP-LN	Wear Part - Liner	See the next pages
10	Medium/Large Ergo Trigger	CWUG2516	WP-CT	Wear Part - Contact Tip	See the next pages
11	Hanger Hook (Optional Extra)	CWUB2517	WP-DF	Wear Part - Diffuser	See the next pages

AIR-COOLED MIG WELDING GUN, M400 SERIES

M400 TE

Rating : 320A CO₂ 270A mixed gas @ 60% duty cycle.
(as Standard IEC EN60974-7) Length 15 ft. (4.5m)

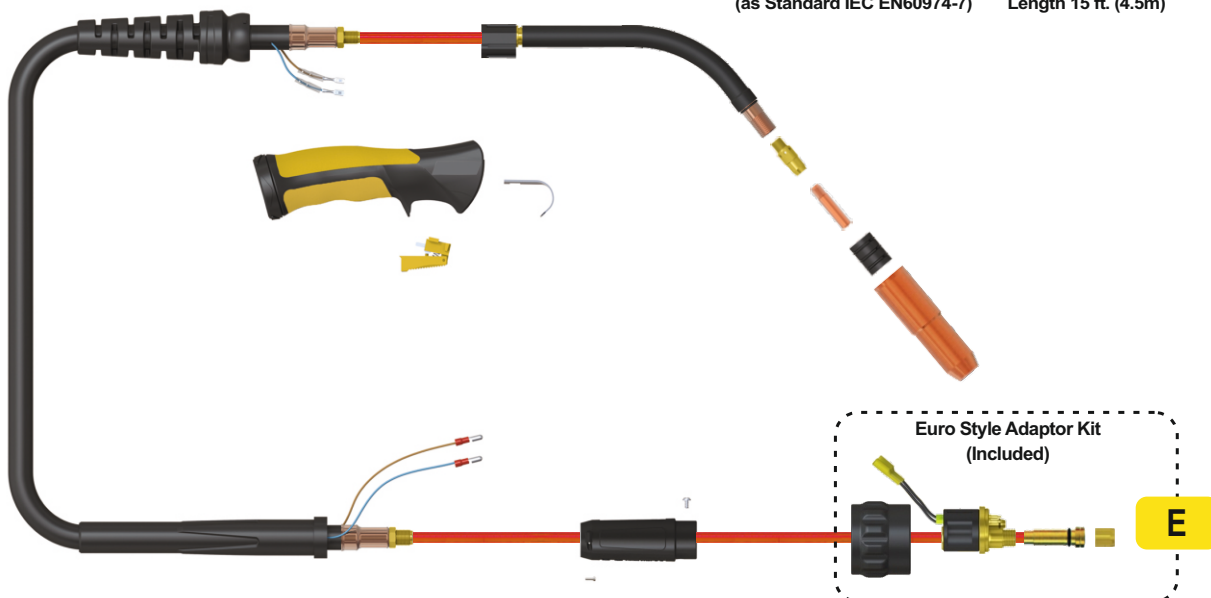

By using one of the following adaptor kits, the termination type of this MIG gun can be changed to another widely used termination types.

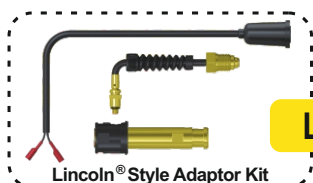

Optional Termination Adaptor Kits

Item	Description	Part Number
L	Lincoln® Style Adaptor Kit	CWUECEL1575K
M	Miller® Style Adaptor Kit	CWUECEM1575K
T	Tweco® Style Adaptor Kit	CWUECET1575K

Wear Part Liners

Part No.	Length	Description	Nipple	Wire Size
CWUA44-3545-15	15 ft. (4.9 m)	Steel Liner X 15FT	Brass Nipple	0.035-0.045 in. (0.9-1.2 mm)
CWUA44-116-15	15 ft. (4.9 m)	Steel Liner X 15FT	Brass Nipple	1/16 in. (1.6 mm)
CWUA44N-116-15	15 ft. (4.9 m)	Polyamide Liner X 15FT	Brass Nipple	1/16 in. (1.6 mm)
CWU42N-4045-15	15 ft. (4.9 m)	Polyamide Liner X 15FT	Brass Nipple	0.040-0.045 in. (1.0-1.2 mm)

Rating : 320A CO₂ 270A mixed gas @ 60% duty cycle.
(as Standard IEC EN60974-7) Length 15 ft. (4.5m)

Wear Part Nozzles

Part No.	Description	Bore	Wall	Material
CWU22AH-50	Nozzle Adjustable	1/2 in. (12.8mm)	3/32 in. (2.25mm)	Copper
CWU22AH-62	Nozzle Adjustable	5/8 in. (16mm)	3/32 in. (2.25mm)	Copper
CWU22AH-75	Nozzle Adjustable	3/4 in. (19mm)	3/32 in. (2.25mm)	Copper
CWU24CT-50S	Nozzle Coarse Thread	1/2 in. (12.8mm)	9/64 in. (3.75mm)	Copper
CWU24CT-62S	Nozzle Coarse Thread	5/8 in. (16mm)	9/64 in. (3.75mm)	Copper
CWU24CT-75S	Nozzle Coarse Thread	3/4 in. (19mm)	9/64 in. (3.75mm)	Copper
CWU34CT	Nozzle Insulator Fixed			

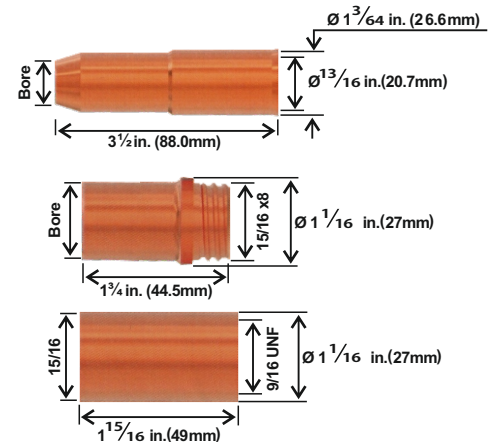

Wear Part Contact Tips

Part No.	Description	Material	Wire Size
CWU14H-30	Contact Tip	Ecu	0.030 in. (0.8mm)
CWU14H-35	Contact Tip	Ecu	0.035 in. (0.9mm)
CWU14H-40	Contact Tip	Ecu	0.040 in. (1.0mm)
CWU14H-45	Contact Tip	Ecu	0.045 in. (1.2mm)
CWU14H-52	Contact Tip	Ecu	0.052 in. (1.3mm)
CWU14H-116	Contact Tip	Ecu	1/16 in. (1.6mm)

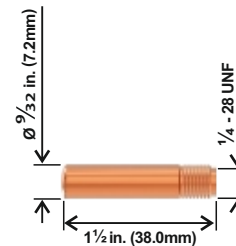

Wear Part Diffuser

Part No.	Description	Material
CWU52A	Diffuser	Brass

