

### TWECO® Style Head TWECO® Style Termination

**M400 TT** is a newly designed, heavy-duty, durable, light weight MIG gun, equipped with a push-on nozzle as well as a comfortable ergonomic handle and Tweco® style torch head with Tweco® style termination.

This MIG gun possesses a unique capability of converting its termination style to other common styles such as Lincoln® style, Miller® style, or Euro style by simply replacing the installed Tweco® style termination kit with the desired one.



## FEATURES

- Knuckle joint for improved balance and position-ability ensures that minor movements of the handle and neck be independent of the cable assembly .
- Excellent heat, abrasion resistance, and flexibility of the cable .
- Lighter than standard cable sets and capable to withstand over 1 million flexes in life testing .
- Extremely durable contact tips manufactured from premium grade copper alloys .
- Standard, durable, and high-performance options for tip adaptors, diffusers, and swan necks .
- Improved insulation and minimized heat transfer to the handle .
- Ergo design handle and comfortable handling .
- Light gun handle, less tiredness of the welder because of the special gun design .

**Rating : 320A CO<sub>2</sub> 270A mixed gas**

**@ 60% duty cycle.**

(as Standard IEC EN60974-7)



#### Recommended For :

**Solid wires: 0.030 to 1/16 in. (0.8 to 1.6 mm)**

**Flux cored wires: 0.030 to 1/16 in. (0.8 to 1.6 mm)**

**Aluminum wires: 0.040 to 1/16 in. (1.0 to 1.6 mm)**

**Gun Length : 15ft. (4.5m)**

#### Recommended Gas Flow :

**22-27 CHF (11-13 l/min)**

**for 1/2 inch (12.8 mm) nozzle bore**

**30-35 CHF (14-17 l/min)**

**for 5/8 inch (16.0 mm) nozzle bore**

**30-40 CHF (14-19 l/min)**

**for 3/4 inch (19.0 mm) nozzle bore**



**TWECO® Style  
Termination**

- Air gap technology for cooler running handles and better heat transfer isolator from the swan neck .
- Steel and combo liner for all kinds of wires such as steel (metalcore and flux-cored), stainless steel (metalcore and flux-cored), and Aluminum .
- Unique sealing ring for effective sealing of impurities especially in the argon gas process .
- Reduction in welder fatigue by improved handle design for welder's comfort .
- Push on nozzle system and easy nozzle stick-out adjustment .
- High-quality trigger with a life expectancy of greater than 1 million cycles .

## AIR-COOLED MIG WELDING GUN, M400 SERIES

**M400 TT**

**Rating : 320A CO<sub>2</sub> 270A mixed gas @ 60% duty cycle.**  
(as Standard IEC EN60974-7)      Length 15 ft. (4.5m)

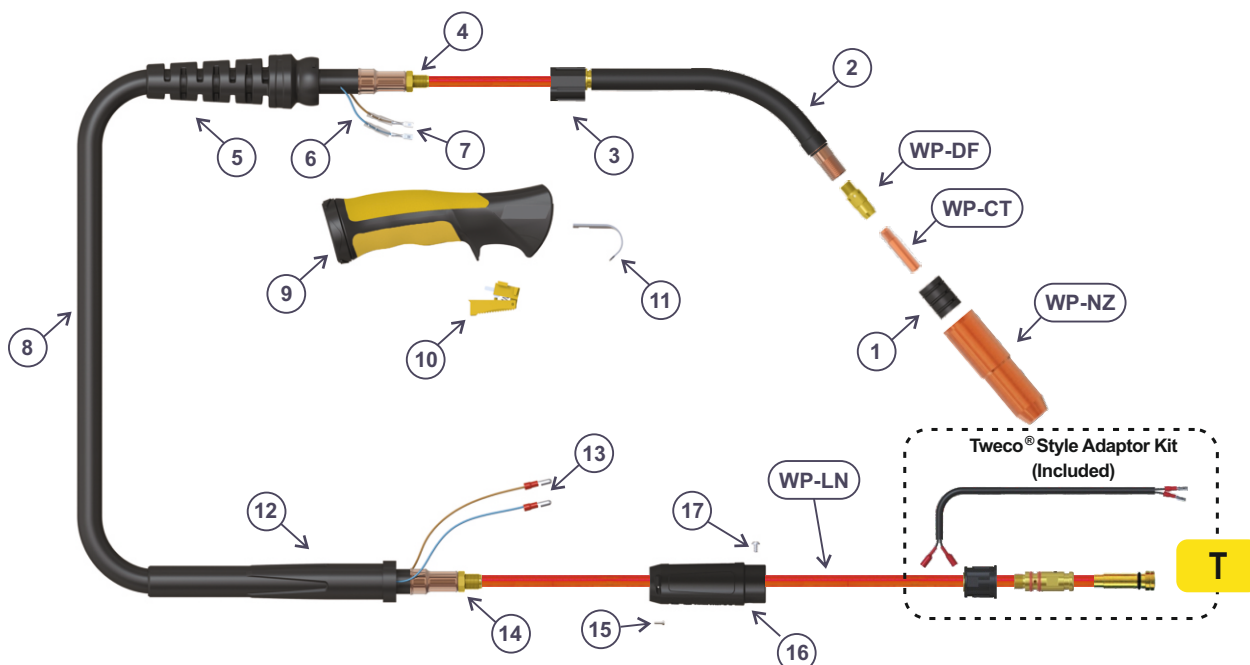

### M400 TT

#### MIG Welding GUN Tweco® Style Termination, 15 ft. (CWGPGTW400-15T)

Item	Description	Part Number	Item	Description	Part Number
1	Adjustable Nozzle Insulator	CWU32	12	Cable Support	CWUC2841
2	Swan Neck Assembly	CWULS-TW2	13	Cable Terminal Male	CWUB1522
3	Ergo Handle Location Body	CWUG1515	14	Cable End Lock Nut (M12 X 1.0)	CWUXL1542
4	Lock Nut	CWUB1505	15	Handle Screw	CWUSCSP1-1
5	Handle Cable Support C/W Ball Joint	CWUG8015-BK	16	Gun Plug Housing	CWUSC2578H/S
6	Cable Terminal Cover	CWUB1521-C	17	Gun Plug Screw	CWUBL1541
7	Cable Terminal	CWUB1521	T	Tweco® Style Adaptor Kit	CWUECET1575K
8	Cable Assembly X 15ft	CWUSTH300-15E	WP-NZ	Wear Part - Nozzle	See the next pages
9	Handle and Lock Nut Assembly	CWUG2514-BK	WP-LN	Wear Part - Liner	See the next pages
10	Medium/Large Ergo Trigger	CWUG2516	WP-CT	Wear Part - Contact Tip	See the next pages
11	Hanger Hook (Optional Extra)	CWUB2517	WP-DF	Wear Part - Diffuser	See the next pages

## AIR-COOLED MIG WELDING GUN, M400 SERIES

**M400 TT**

Rating : 320A CO<sub>2</sub> 270A mixed gas @ 60% duty cycle.  
 (as Standard IEC EN60974-7) Length 15 ft. (4.5m)

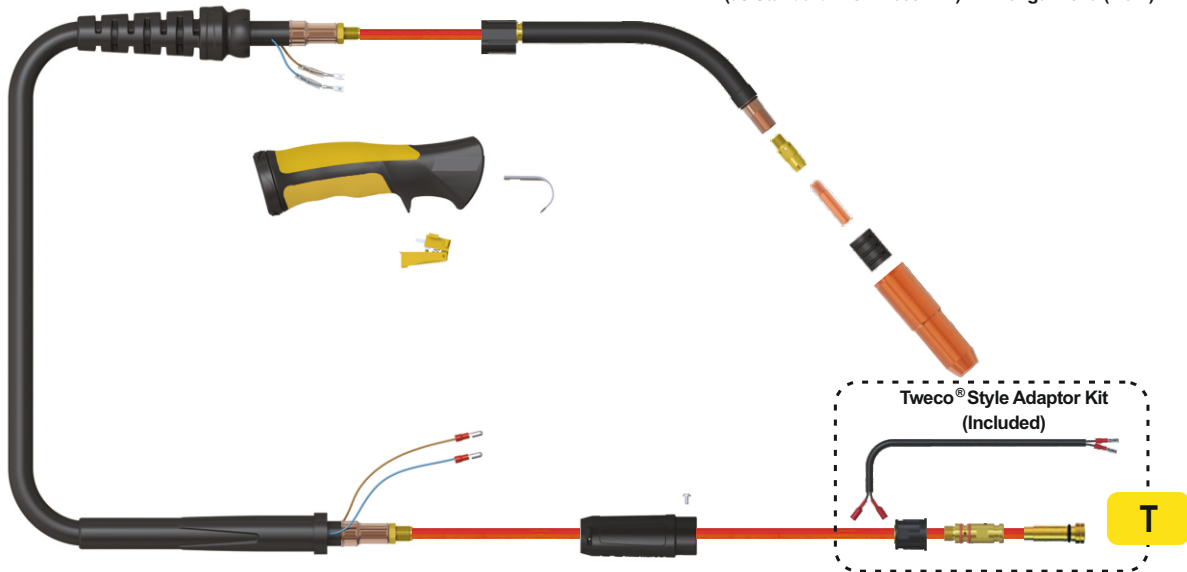

By using one of the following adaptor kits, the termination type of this MIG gun can be changed to another widely used termination types.



### Optional Termination Adaptor Kits

Item	Description	Part Number
L	Lincoln® Style Adaptor Kit	CWUECEL1575K
M	Miller® Style Adaptor Kit	CWUECEM1575K
E	Euro Style Adaptor Kit	CWUECEE1575K

### Wear Part Liners

Part No.	Length	Description	Nipple	Wire Size
CWUA44-3545-15	15 ft. (4.9 m)	Steel Liner X 15FT	Brass Nipple	0.035-0.045 in. (0.9-1.2 mm)
CWUA44-116-15	15 ft. (4.9 m)	Steel Liner X 15FT	Brass Nipple	1/16 in. (1.6 mm)
CWUA44N-116-15	15 ft. (4.9 m)	Polyamide Liner X 15FT	Brass Nipple	1/16 in. (1.6 mm)
CWU42N-4045-15	15 ft. (4.9 m)	Polyamide Liner X 15FT	Brass Nipple	0.040-0.045 in. (1.0-1.2 mm)



## AIR-COOLED MIG WELDING GUN, M400 SERIES

**M400 TT**

**Rating : 320A CO<sub>2</sub> 270A mixed gas @ 60% duty cycle.**  
(as Standard IEC EN60974-7)      Length 15 ft. (4.5m)

### Wear Part Nozzles

Part No.	Description	Bore	Wall	Material
CWU22AH-50	Nozzle Adjustable	1/2 in. (12.8mm)	3/32 in. (2.25mm)	Copper
CWU22AH-62	Nozzle Adjustable	5/8 in. (16mm)	3/32 in. (2.25mm)	Copper
CWU22AH-75	Nozzle Adjustable	3/4 in. (19mm)	3/32 in. (2.25mm)	Copper
CWU24CT-50S	Nozzle Coarse Thread	1/2 in. (12.8mm)	9/64 in. (3.75mm)	Copper
CWU24CT-62S	Nozzle Coarse Thread	5/8 in. (16mm)	9/64 in. (3.75mm)	Copper
CWU24CT-75S	Nozzle Coarse Thread	3/4 in. (19mm)	9/64 in. (3.75mm)	Copper
CWU34CT	Nozzle Insulator Fixed			

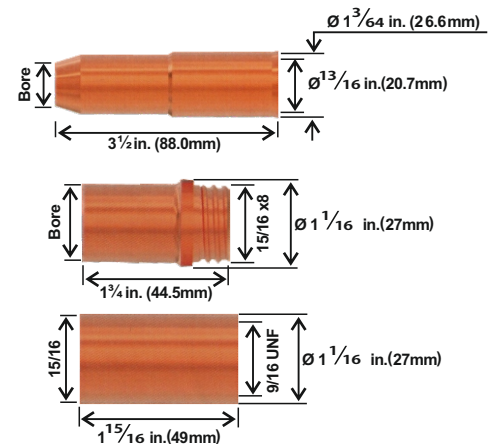

### Wear Part Contact Tips

Part No.	Description	Material	Wire Size
CWU14H-30	Contact Tip	Ecu	0.030 in. (0.8mm)
CWU14H-35	Contact Tip	Ecu	0.035 in. (0.9mm)
CWU14H-40	Contact Tip	Ecu	0.040 in. (1.0mm)
CWU14H-45	Contact Tip	Ecu	0.045 in. (1.2mm)
CWU14H-52	Contact Tip	Ecu	0.052 in. (1.3mm)
CWU14H-116	Contact Tip	Ecu	1/16 in. (1.6mm)

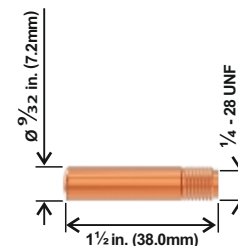

### Wear Part Diffuser

Part No.	Description	Material
CWU52A	Diffuser	Brass

