

AIR-COOLED TIG WELDING TORCH CT-26 VF-E

Rating: 180A DC 125A AC @ 35% duty cycle

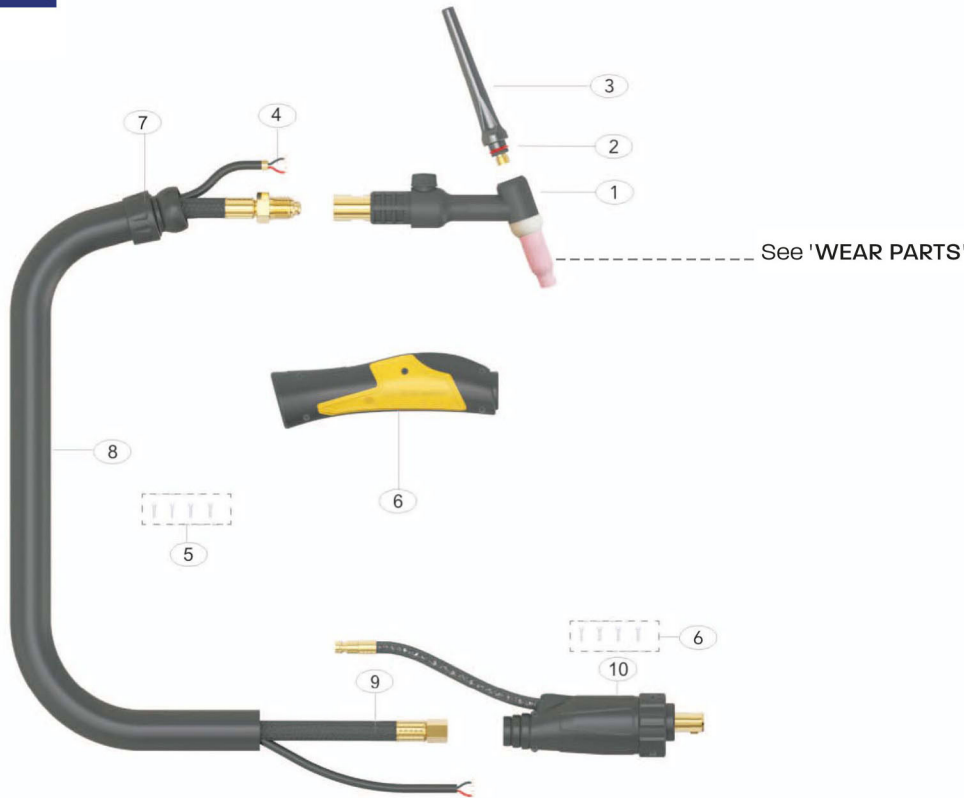

Model	Part Number	
Description	12ft	25ft
CT-26 VF TIG TORCH	CWCAN-SG26VFX-S1-12-SL-S4	CWCAN-SG26VFX-S1-25-SL-S4

Spare parts					
Part Number	Description				
1	CWWP26FX	Torch Body Flexible	7	CWPT-ERKJ200	Large Knuckle Joint
2	CW98W18	Back Cap 'O' Ring	8	CWPL200-40	Neoprene Cover Assembly X 4m
3	CW57Y02	Back Cap Long		CWPL200-80	Neoprene Cover Assembly X 8m
4	CW3100224216-4.2	Switch Wire 4m	9	CWPGD46V28OB-EPC2	Power Cable×4m O/B Rubber
	CW3100224216-7.7	Switch Wire 8m		CWPGD46V30OB-EPC2	Power Cable×8m O/B Rubber
5	CWERSP1	Screw	10	CWML3550-M12-L-G7	Power Adaptor 8.9mm QF
6	CWEKH200	Large Ergo Tig Handle			

Gas Feed Hose

Part Number	Description
CWGS4	Gas Supply Hose C/W 8.9mm Quick Fit

